



MEQ-433-01-SMA

433 MHz ISM Connector Mount
Part #: 100-00229-01



Description

The MEA-411-01-SMA is a high efficient screw-mount ISM band antenna operating at 433MHz. The antenna is also offered for 433 MHz, 868MHz & 915MHz applications. This antenna was designed for LoRa & Sigfox IOT applications in mind. The high efficiency and high gain design provide the antenna consistent and stable connectivity.

The antenna housing consists of black UV resistant plastic, IP 56 rated housing, and a SMA male connector. The small size and high performance make this antenna an ideal solution for any ISM type of applications.

Electrical Specification

Parameter	Specification
Frequency Range	433-435 MHz
Band	433 MHz
Return Loss	-15.0 dB
VSWR	1.4:1
Efficiency	51.7%
Peak Gain	-0.6 dBi
Average Gain	-2.9 dB
Impedance	50 Ω
Polarization	Linear
Radiation Pattern	Omni-Directional
Max Input Power	25 W

Mechanical Specification

Parameter	Specification
Antenna Dimensions	Ø 9 x 48 mm
Operating Temperature	-40°C to + 85°C
Mounting Type	Connector Mount
Connector	SMA-Male Standard (Other Connectors Available)
Radome Type	TPC-ET
Radome Color	Black
Substance Compliance	RoHS

Mounted on Ground Plane of 150x50 mm

Features

- Small Form Factor
- High Performance
- Frequency range 433-435MHz
- Antenna size D x H (9 x 48.0mm)
- RoHS Compliant
- Connector Type: SMA Male

Applications

- Public safety
- M2M applications
- Wireless applications
- Smart meters
- Transportation
- Mesh network

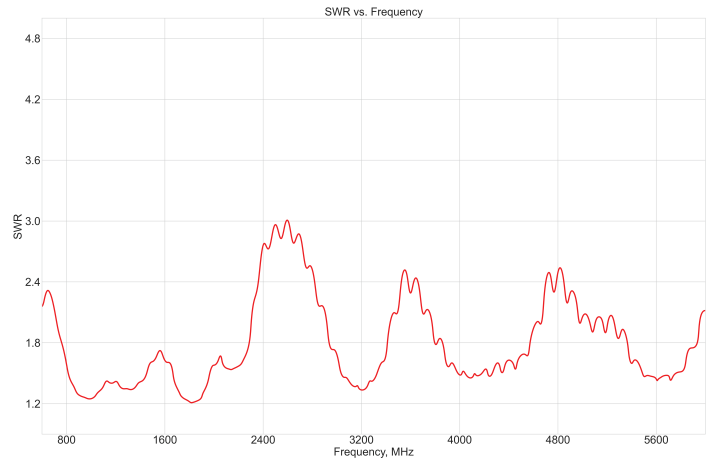
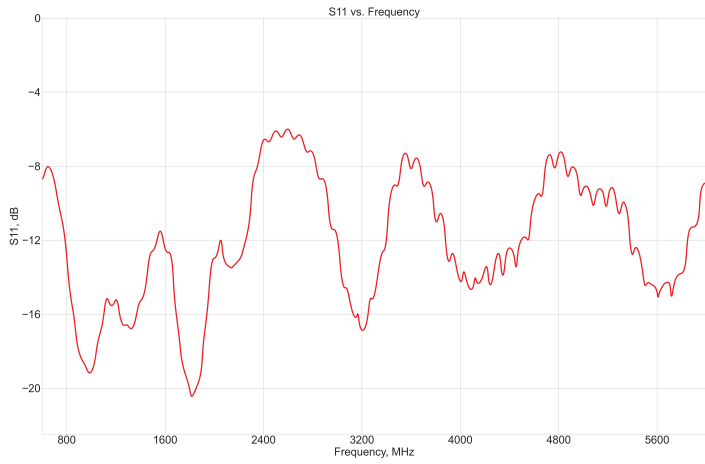

Maxtena Inc.
 7361 Calhoun Place, Suite 102
 Rockville, MD 20855
 1-877-629-8362
 info@maxtena.com
www.maxtena.com

DRAWING REVISION HISTORY			
REV	DESCRIPTION	DATE	BY
A	INITIAL RELEASE	2022-01-14	JET

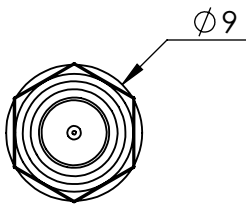
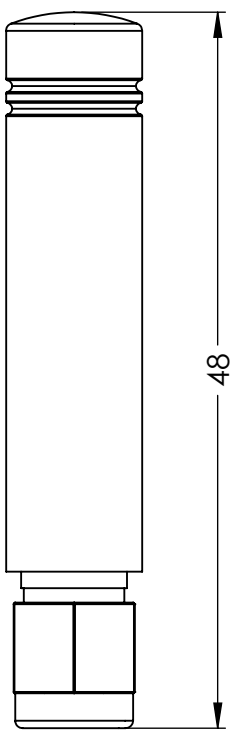

- NOTES:
- FREQUENCY (ISM, LoRa): 433-435 MHz
 - MOUNTING TYPE: CONNECTOR MOUNT
 - MATERIALS:
 - RADOME: TPC-ET
 - RADOME COLOR: BLACK
 - OPERATING TEMPERATURE: -40° C ~ +85° C
 - STORAGE TEMPERATURE: -40° C ~ +85° C

ITEM 100-00229 REVISION HISTORY			
REV	DESCRIPTION	DATE	BY
A	INITIAL RELEASE	2022-01-14	JET

100-00229 CONFIGURATION TABLE		
DASH NO	CONNECTOR TYPE	RADOME COLOR
-01	SMA-MALE	BLACK

UNLESS OTHERWISE SPECIFIED:

DIMENSIONS ARE IN MM
TOLERANCES:
FRACTIONAL ±
ANGULAR: MACH ± .5° BEND ±
ONE PLACE DECIMAL ± 1.0
TWO PLACE DECIMAL ± .50

	NAME	DATE
DRAWN	JET	2022-01-14
CHECKED	ZX	2022-01-14
ENG APPR.	NPC	2022-01-14
MFG APPR.		
	Q.A.	

INTERPRET GEOMETRIC TOLERANCING PER:

THIRD ANGLE PROJECTION

DO NOT SCALE DRAWING

CAD MAINTAINED. CHANGES SHALL BE INCORPORATED BY THE DESIGN ACTIVITY.

MAXTENA, INC

TITLE: 100-00229
MEA-433-01-SMA

SIZE	DWG. NO.	REV
B	117-00564-01	A

CAGE CODE: 5KQH7 SCALE: NONE SHEET 1 OF 1

PROPRIETARY AND CONFIDENTIAL
THE INFORMATION CONTAINED IN THIS DRAWING IS THE SOLE PROPERTY OF MAXTENA, INC. ANY REPRODUCTION IN PART OR AS A WHOLE WITHOUT THE WRITTEN PERMISSION OF MAXTENA, INC IS PROHIBITED.

Mouser Electronics

Authorized Distributor

Click to View Pricing, Inventory, Delivery & Lifecycle Information:

[Maxtena:](#)

[MEA-433-01-SMA](#)