

ME A-698-3800-SM

5G LOW PROFILE LTE ANTENNA

Part #: 100-00132-01



Description

The MEA-698-3800-SM is a high-performance 5G LTE antenna with SMA-Male connector. This antenna provides MiMo functionality for 2G/3G/4G/5G covering 698-3800 MHz. This low-profile antenna is designed to provide industry leading wide-band performance and optimal coverage. The MEA-698-3800-SM antenna consists of black ABC housing resistant plastic.

Electrical Specifications

Parameter	Specification
Frequency Range	698-3800 MHz
Impedance	50 Ω
Return Loss	-10 dBi
VSWR	≤ 2.5
Gain	5.5 dBi

Mechanical Specifications

Parameter	Specification
Antenna Dimensions	59 x 71mm
Operating Temperature	-40 °C to +80 °C
Antenna Radome Material	PC + ABS
Connector	SMA Male
Antenna Color	Black
ROHS Compliant	Yes

Features

- Low profile antenna
- Covers large frequencies 698-3800 MHz
- ROHS Compliant
- High gain for the antenna size
- PC + ABC housing
- Exceptional performance over the main 4G/5G bands

Applications

- M2M applications
- IoT applications
- Vending machines
- Payment terminals
- Remote monitoring

Radiation Specifications

698-960 MHz

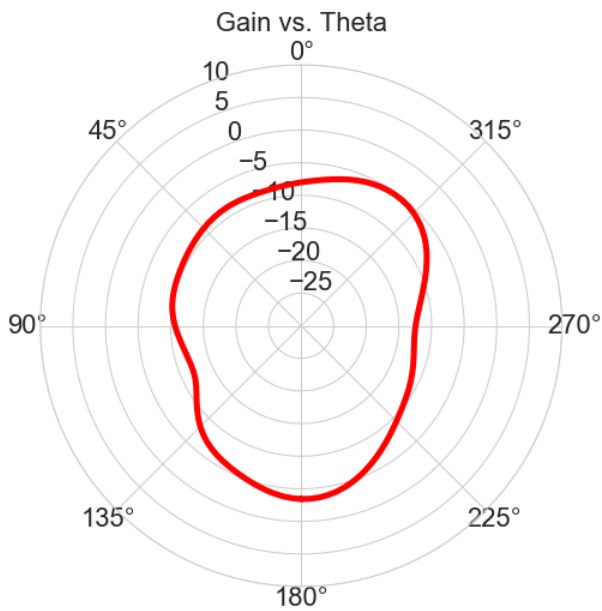
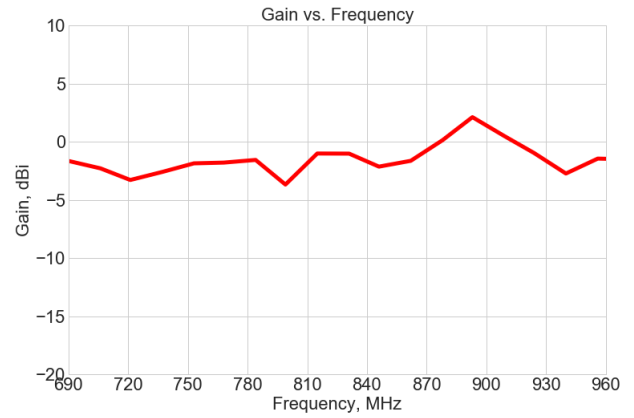
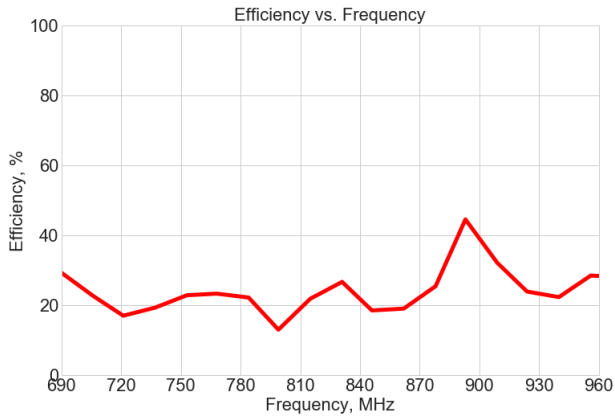

Gain dBi, Elevation Cut $\Phi = 0$, Frequency 799.40(MHz)

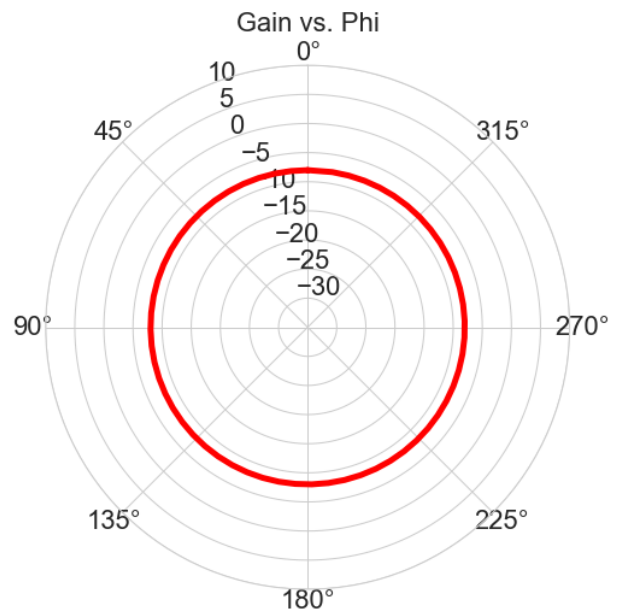

Gain dBi, Conical Cut $\Theta = 45$, Frequency 799.40(MHz)

Radiation Specifications

1710-2700 MHz

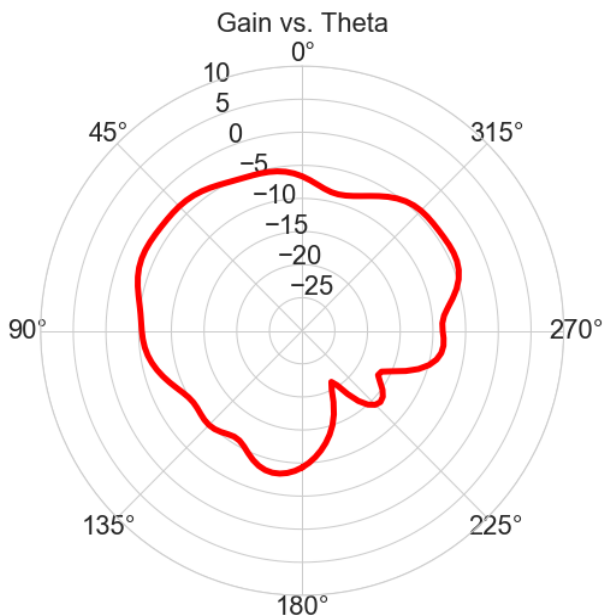
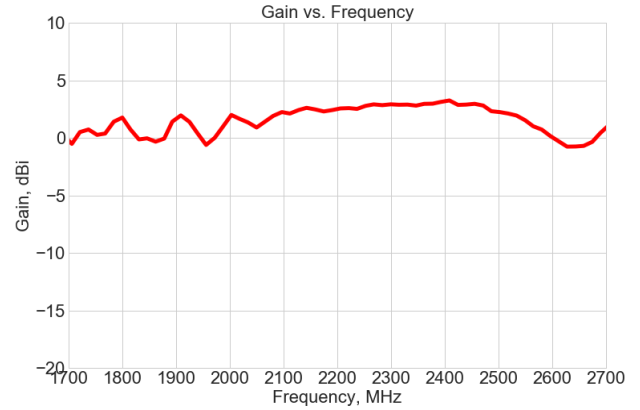
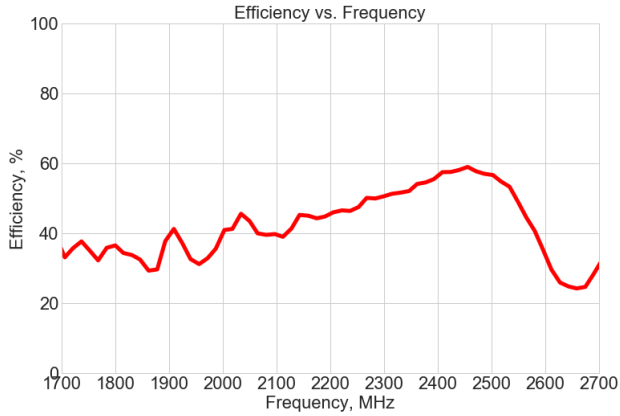

Gain dBi, Elevation Cut $\Phi = 0$, Frequency 1799.60(MHz)

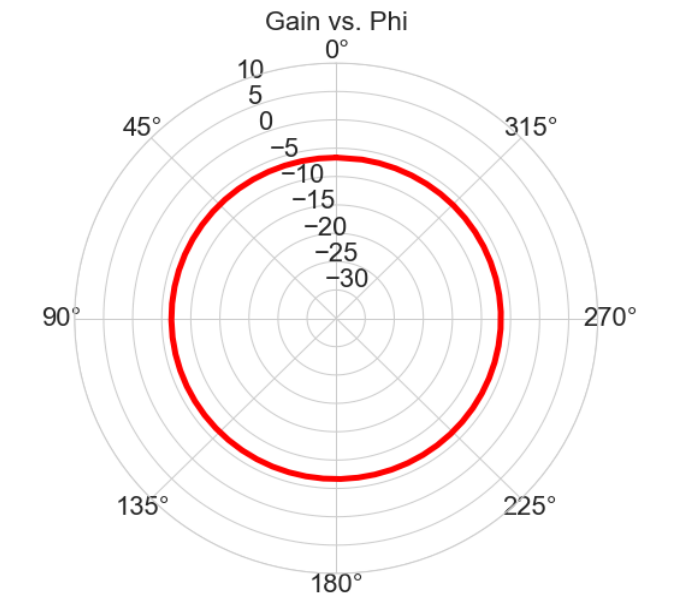

Gain dBi, Conical Cut $\Theta = 45$, Frequency 1799.60(MHz)

Radiation Specifications

2500-2700 MHz

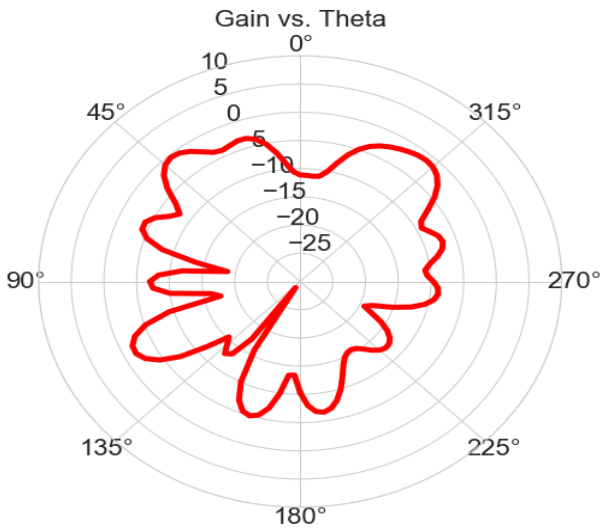
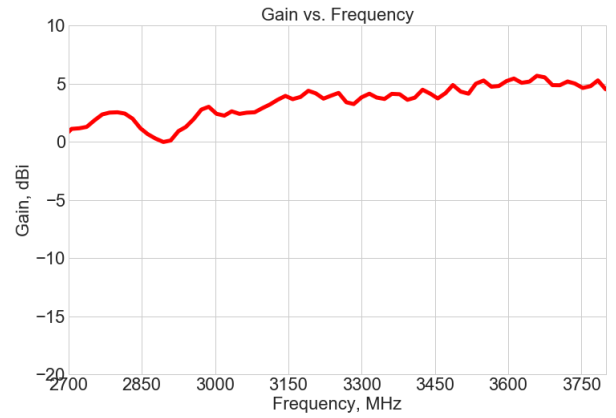
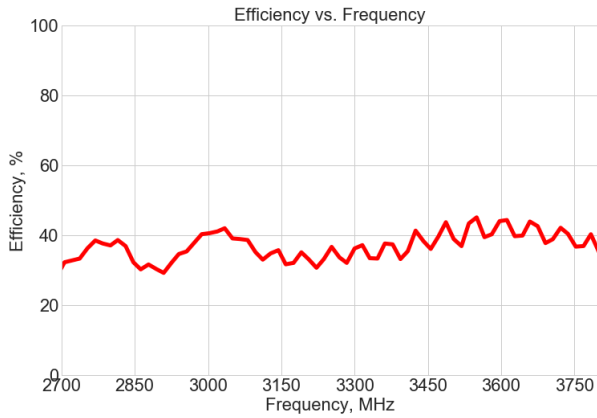

Gain dBi, Elevation Cut $\Phi = 0$, Frequency 3206.13(MHz)

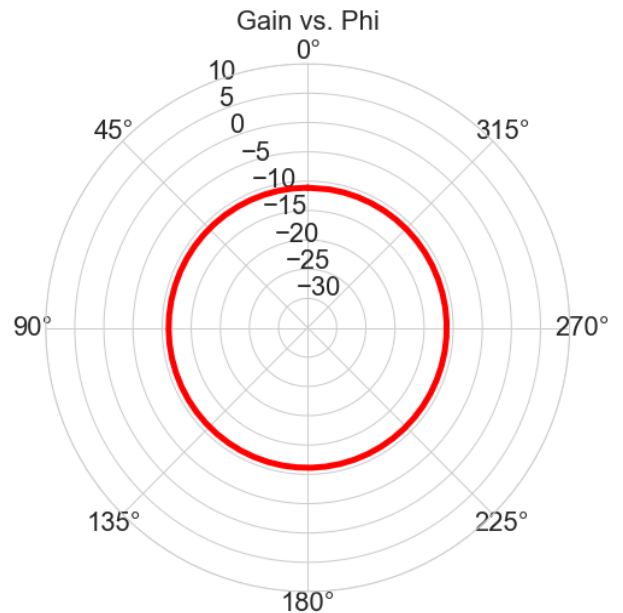

Gain dBi, Conical Cut $\Theta = 45$, Frequency 3206.13(MHz)

DRAWING REVISION HISTORY			
REV	DESCRIPTION	DATE	BY
A	INITIAL RELEASE	2020-04-06	ZX

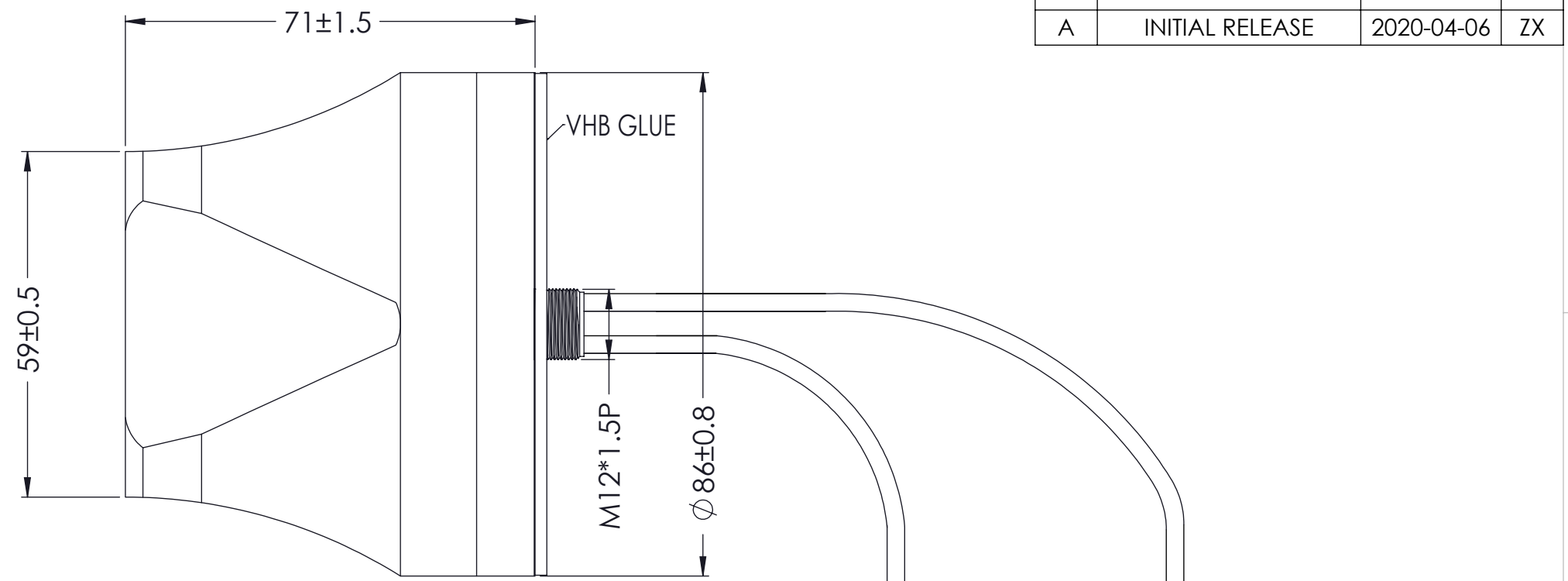
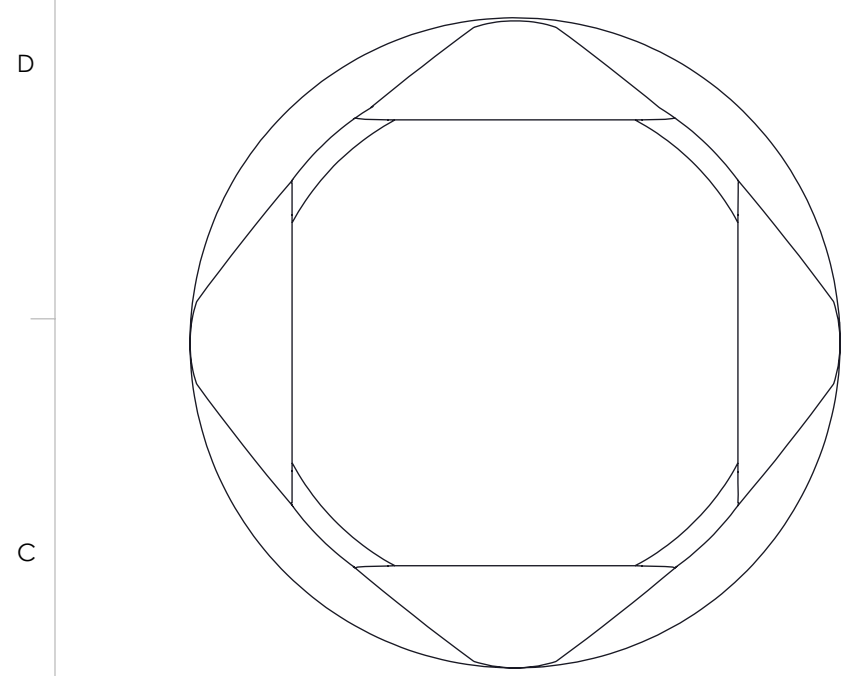

Electrical Properties	
Frequency Range	698~3800MHZ
Impedance	50 Ω
V.S.W.R.	≤2.5
Radiation	Omni
Gain	2.0±0.5dBi
Polarization	Vertical
Mechanical Properties	
Random	PC+ABS
Standard Connector	SMA MALE
Weight	- g(est)
Operating Temp	- 40°~ + 80°

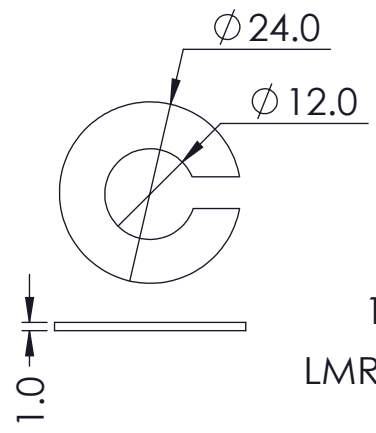
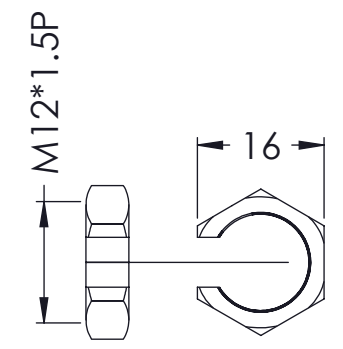
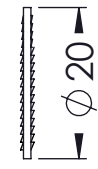

1/4-36UNS-2B
LMR100 CABLE 2000mm±100

1/4-36-UNS-2B
LMR100 CABLE 2000mm±100

ITEM 100-00132-01 REVISION HISTORY			
REV	DESCRIPTION	DATE	BY
1	INITIAL RELEASE	2020-04-06	ZX

PROPRIETARY AND CONFIDENTIAL

THE INFORMATION CONTAINED IN THIS DRAWING IS THE SOLE PROPERTY OF MAXTENA, INC. ANY REPRODUCTION IN PART OR AS A WHOLE WITHOUT THE WRITTEN PERMISSION OF MAXTENA, INC IS PROHIBITED.

UNLESS OTHERWISE SPECIFIED:	NAME	DATE
DIMENSIONS ARE IN MM	DRAWN	ZX 2020-04-06
TOLERANCES:	CHECKED	
FRACTIONAL ±	ENG APPR.	NPC 2020-04-06
ANGULAR: MACH ± .5° BEND ±	MFG APPR.	
ONE PLACE DECIMAL ± .2	Q.A.	
TWO PLACE DECIMAL ± .10		
INTERPRET GEOMETRIC TOLERANCING PER:	CAD MAINTAINED. CHANGES SHALL BE INCORPORATED BY THE DESIGN ACTIVITY.	
	DO NOT SCALE DRAWING	

MAXTENA, INC		
TITLE: 100-00132-01 MEA-698-3800-SM		
SIZE	DWG. NO.	REV
B	117-00324-01	A
CAGE CODE: 5KQH7	SCALE: NONE	SHEET 1 OF 1